

SECTION THROUGH NAVE LOOKING WEST

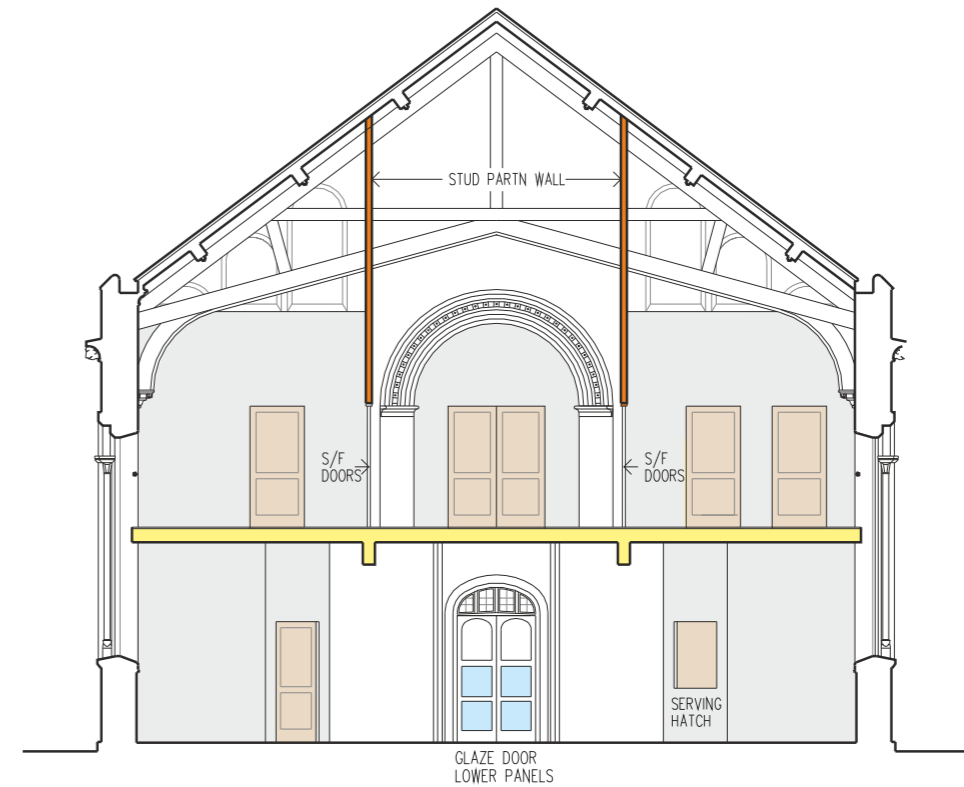

SECTION THROUGH PROPOSED MEETING ROOMS LOOKING WEST

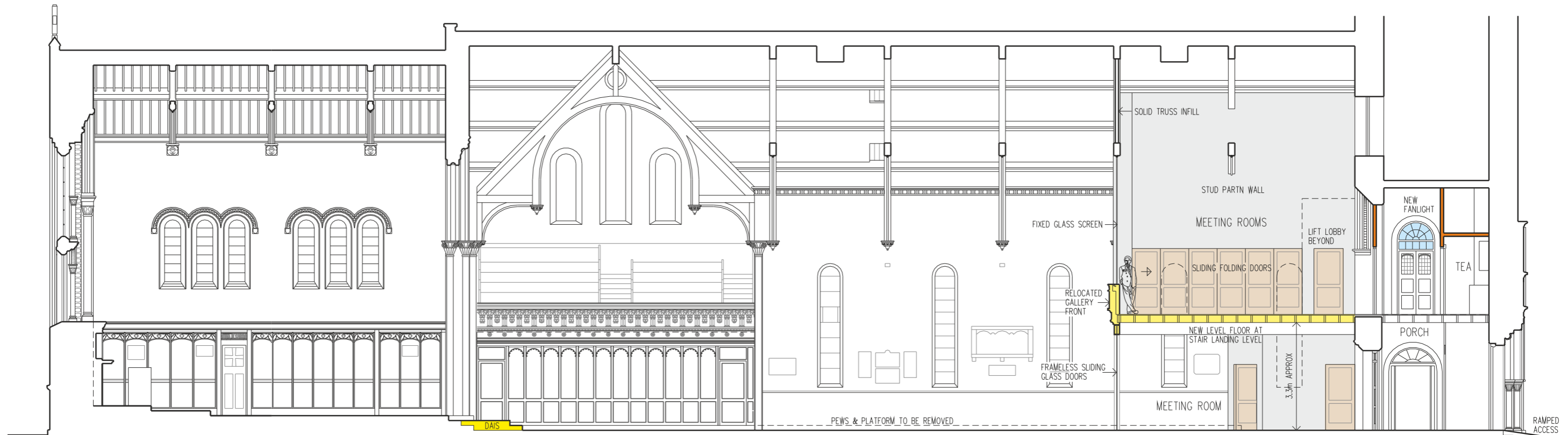

LONGITUDINAL SECTION THROUGH CHURCH LOOKING NORTH

READ THIS DRAWING IN CONJUNCTION WITH DRAWINGS A16-17 & 18

ROBIN WOLLEY B.Arch RIBA AABC
 CHARTERED ARCHITECT AND HISTORIC BUILDINGS CONSULTANT
 The Studio Efenecthyd Nr Ruthin LL15 2PW Tel: 01824 703279 Fax: 01824 705523
 email: robin.wolley@btconnect.com

PROJECT
AIGBURTH ST ANNE CHURCH REORDERING
 DRAWING TITLE
SECTIONS AS PROPOSED

SCALE
1:125 [A3]
 DRAWING No
A16-SK19
 DATE
02.17
 REVISION